

# **Proposed Layout and Estimated Budget Cost Restoration of old Pope's Dime Store/Super 10 into Fairmont Community Center**

The budget cost includes the following items:

1. Demolition
2. Concrete Floor, right side of building
3. New Restrooms
4. Kitchen (Non-Commercial, Catering only)
5. New Storefront
6. Exterior Exit (rear)
7. New Ceilings (Acoustical Lay-in)
8. New Floor Covering (VCT)
9. Drywall over existing walls
10. Folding Partition Doors
11. Stage
12. Storage and electrical rooms
13. Painting
14. Front Brick work
15. Electrical
16. HVAC
17. Plumbing
18. Design/Engineering (Subtotal Items 1-18: \$328,300.00)
19. Roof (\$32,600.00)

**Total Budget Cost: \$360,900.00**

Building Size: 64'W x 111'L = 7,104 square feet. Walls are 11' tall.

(The Fire Hall is only 38'W x 51'L = 1,938 square feet.)

*Building Layout on reverse →*

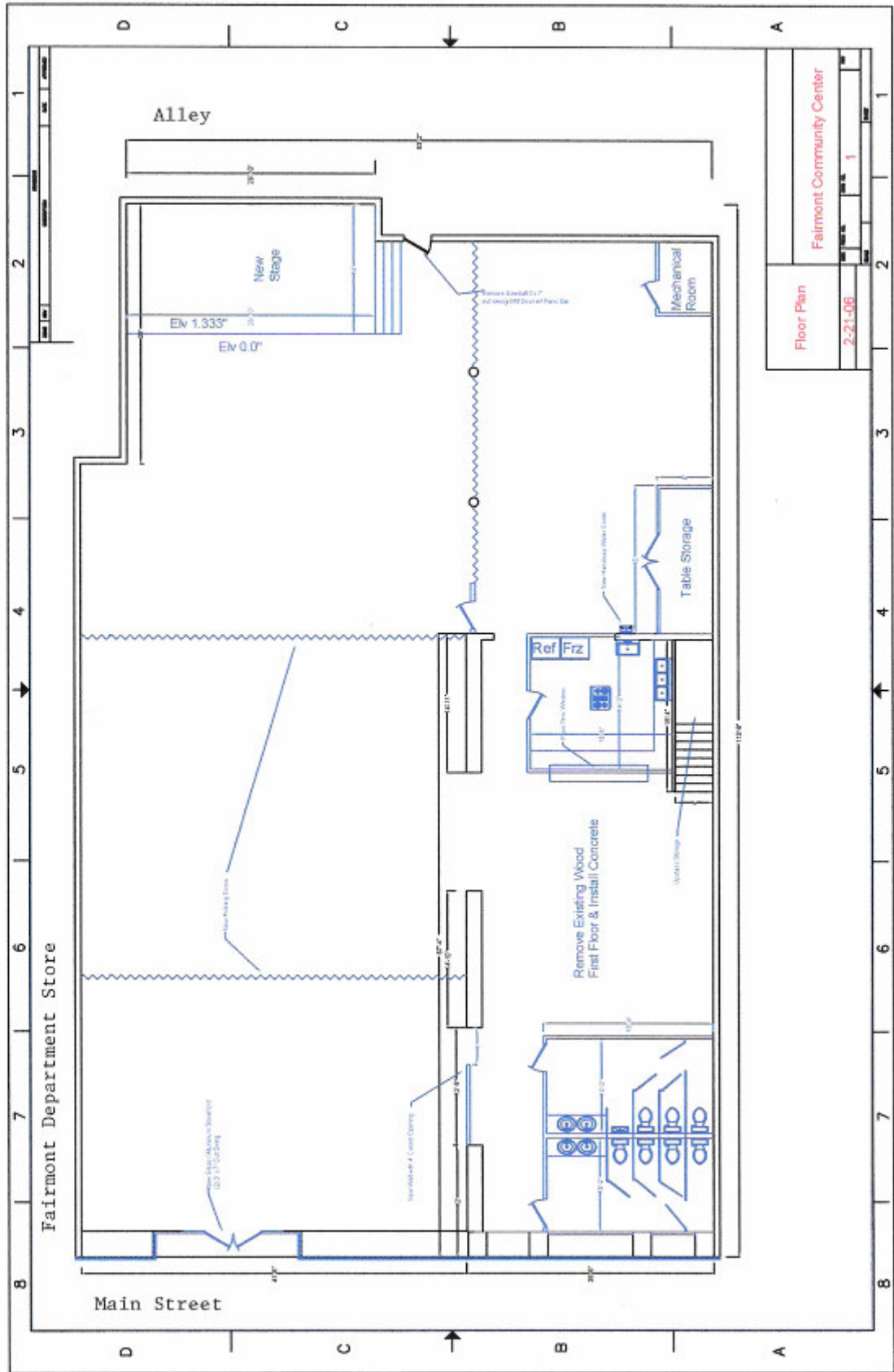



**Old Pope's Dime Store/Super 10 Building**